

Aluminum Instrument Cases

Versatile Multi-Mod™ cases are ideal for small case packaging of testers, controllers and other instruments. Brushed aluminum construction provides excellent RF attenuation and an attractive “finished” appearance. Kits include frame, top and bottom covers and hardware. Extruded two-piece frame assemblies quickly with self-tapping screws. Standard 0.062” cards slide into grooves in Frame-Loc Rails.



Model: W30-66-46B - closed



Model: W30-66-46B - open

Frame-Loc
Rails™

Part No.	Width	Length	Height	Circuit Card Size Range
W45-10-66B	4.5"	10.00"	6.64"	9.88" x 6.50"
W45-10-46B	4.5"	10.00"	4.61"	9.88" x 4.50"
W45-86-46B	4.5"	8.61"	4.61"	8.50" x 4.50"
W45-66-46B	4.5"	6.61"	4.61"	6.50" x 4.50"
W30-10-66B	3.0"	10.00"	6.61"	9.88" x 6.50"
W30-86-46B	3.0"	8.61"	4.61"	8.50" x 4.50"
W30-66-46B	3.0"	6.61"	4.61"	6.50" x 4.50"
W20-66-46B	2.0"	6.61"	6.61"	6.50" x 4.50"
W20-46-31B	2.0"	4.61"	3.10"	4.50" x 2.98"
W16-31-31B	1.6"	3.10"	3.10"	2.98" x 2.98"

Frame-Loc Rails™ - for Cases or P.C. Board Racks & Carriers

Ideal for applications requiring quick, versatile packaging. Frame-Loc Rails™ can be cut or bent to form enclosures of virtually any size. Aluminum construction with 0.062” grooves accommodate most Vectorbord printed circuit boards. Four available widths. Standard length is 41”, shorter lengths can be ordered using table below. Standard finish is clear anodize. Attach rails at 90° with BR64A corner brackets.

Ordering Table

SR 16 - 2 0 . 0 0 - S

Width Length
(inches)

16 = 1.6"
2 = 2.0"
3 = 3.0"
45 = 4.5"

S = 90° (Square)
M = 45° (Mitre)

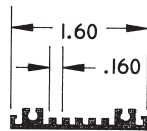
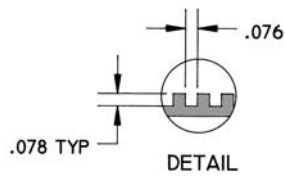

SR 16

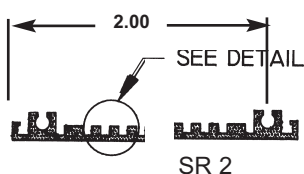

SR 2

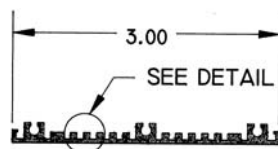

SR 3

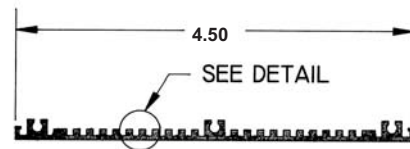

SR 45

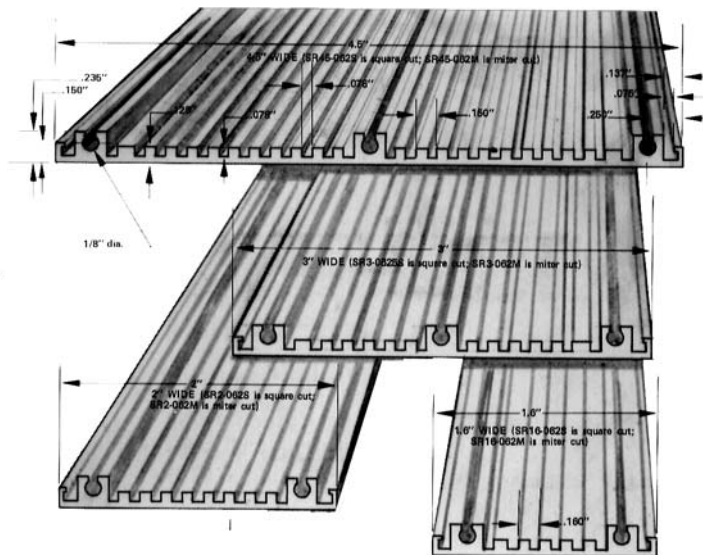

REVISIONS				
ZONE	REV.	DESCRIPTION	DATE	APPROVED
ALL	N	INC. ECO 2942	08/06/85	
	P	INC. ECO 3041	11/19/85	
	Q	EAR 1123	05/06/98	
	R	ADDED DIE NO.	10/21/09	

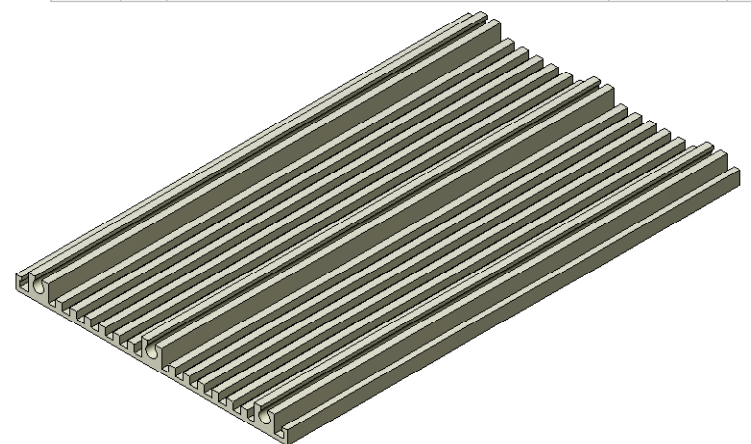

**SR16-062
PARAMOUNT DIE NO. P-6650**

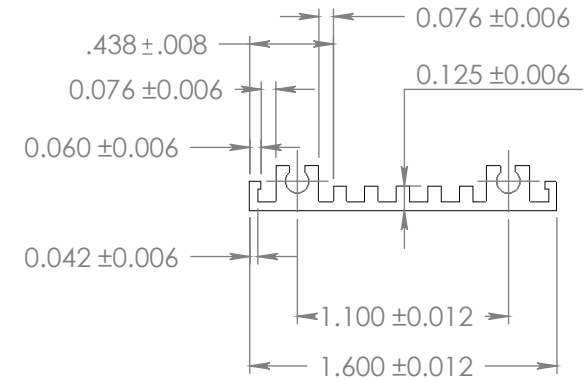

**SR3-062
PARAMOUNT DIE NO. 6652**

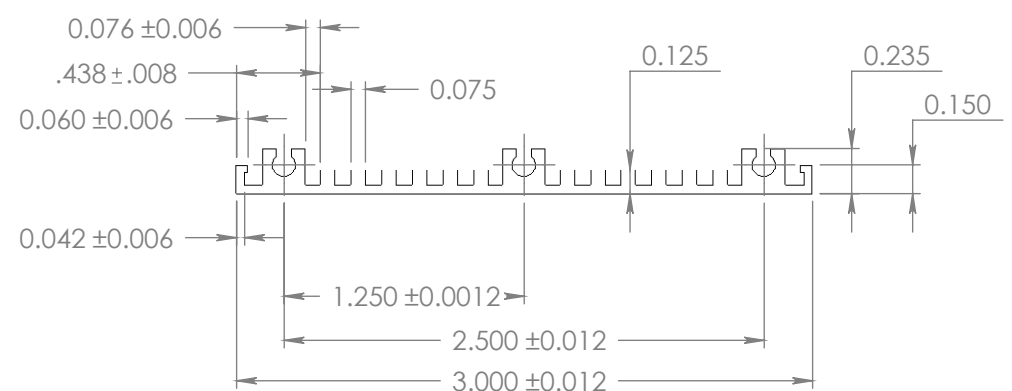

**SR2-062
PARAMOUNT DIE NO. 6651**

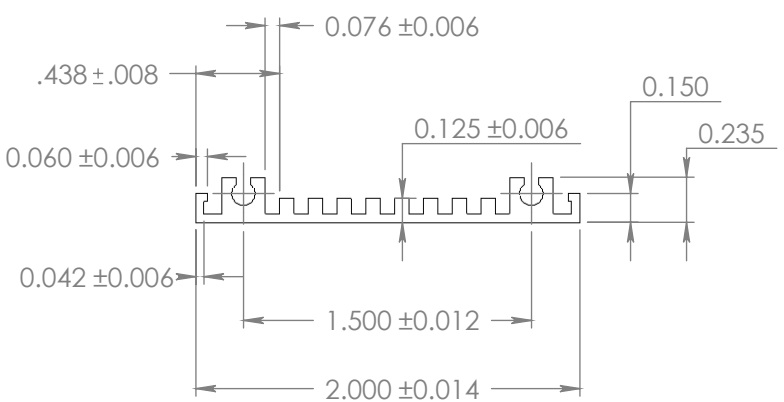

SR45-062

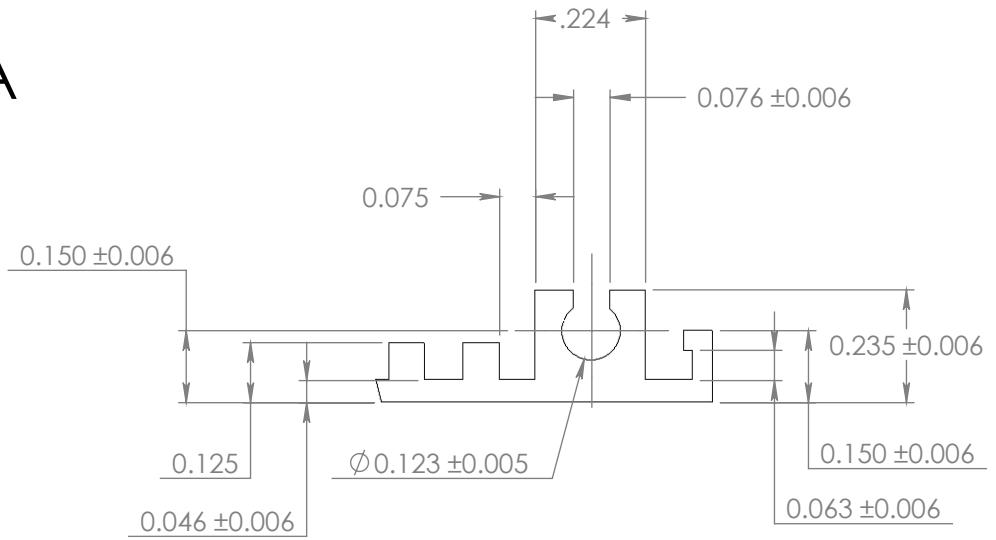
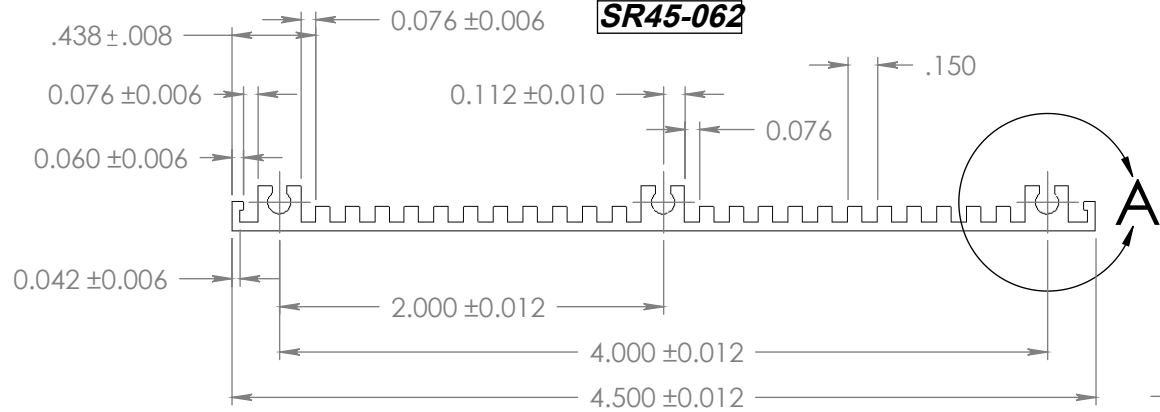

DETAIL A
SCALE 2.5 : 1

P/N	FINISH 10
SR16-062	ANOD.
SR2-062	ANOD.
SR3-062	ANOD.
SR45-062	NONE

- 10 FINISH ANOD., CLEAR TYPE II, CLASS 1, IAW MIL-A-8625
- 9 GRAIN FINISH (PRIOR TO ANOD.)
- 8 PROTECT SURFACE DURING SHIPMENT TO AVOID MARKING & SCRATCHING.
(MAX. WEIGHT/BUNDLE : 250 LBS)
- 7 TWISTS : 2° / FT
- 6 MAX R ON ALL INTERNAL & EXTERNAL CORNERS : 0.010
- 5 SURFACE TO BE STRAIGHT WITHIN 0.012/FT
- 4 FLATNESS 0.015/FT IN LENGTH, 0.004/INCH IN WIDTH
- 3 EXTRUDED LENGTH: 7' - 2' (2' IS CUTED AT EACH END FOR ANODIZING CLAMPS)
- 2 EXTRUDED FINISH : #2(60 RMS)
- 1 MAT'L. 6063-T52

NOTES: UNLESS OTHERWISE SPECIFIED.

PROPRIETARY AND CONFIDENTIAL
THE INFORMATION CONTAINED IN THIS DRAWING IS THE SOLE PROPERTY OF VECTOR ELECTRONICS & TECH., INC. ANY REPRODUCTION IN PART OR AS A WHOLE WITHOUT THE WRITTEN PERMISSION OF VECTOR ELECTRONICS & TECH., INC. IS PROHIBITED.

UNLESS OTHERWISE SPECIFIED:		NAME	DATE	<p>11115 VANOWEN ST., NORTH HOLLYWOOD, CA 91605</p>	
DIMENSIONS ARE IN INCHES		DRAWN	TRUSHAR		12/06/07
TOLERANCES:		CHECKED			
FRACTIONAL ±		ENG APPR.			
ANGULAR: ±.5°		MFG APPR.			
TWO PLACE DECIMAL ±.03		Q.A.			
THREE PLACE DECIMAL ±.010		THIRD ANGLE PROJECTION			
INTERPRET DRAWINGS PER: THIRD ANGLE PROJECTION					
MATERIAL					
FINISH					
NEXT ASSY					
USED ON					
APPLICATION					
DO NOT SCALE DRAWING					

DETAIL, EXTRUSION SIDE RAIL		
SIZE	DWG. NO.	REV
B	M4211D5.1	R
SCALE: 1:3	WEIGHT:	SHEET 1 OF 1